

# Comfortlite T-Shaped Corded Earplugs

## Product description

Maxisafe Comfortlite T-shaped earplugs is made from soft foam to deliver maximum protection and enhanced comfort. Its T-shaped makes fitting and removal effortless.

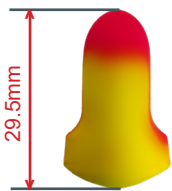

## Features and Benefits

- Comfortable T-shape style for easy insertion
- Soft low pressure PU foam expands gently for comfortable long term comfort
- High visibility colour for worker compliance
- Comfortable earplugs with high attenuation
- Corded style to prevent earplugs from being lost or dropped
- Class 5 SLC80 26dB
- Certified to AS/NZS 1270:2002

## Fitting Instructions

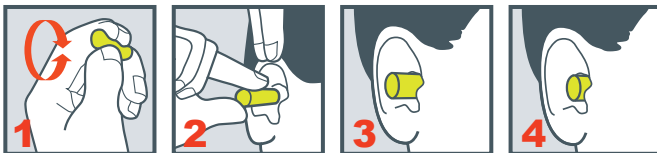

1. Before using ear plugs, ensure hands are clean. Roll ear plugs between fingers to compact foam.
2. Pull top of ear up and out while inserting earplug. This straightens out the ear canal. Insert ear plug as far as possible into the ear canal. Hold for approx 60 seconds to allow foam to expand.
- 3&4. When ear plugs are inserted correctly the top of the ear plug should be as per fig 4. To test fit cup both hands over your ears. When you pull them away you should notice a significant difference in noise levels. If unsure consult your safety officer.

## Care / Usage - Disposable Earplugs

**Inspect:** Prior to fitting, examine earplugs for dirt, damage or hardness discard immediately if compromised.

**Discard:** Discard disposable earplugs after each use.

**Hygiene:** To maintain hygiene standards, disposable earplugs should be discarded at the end of every shift.

## HLU630



## HLC631



## Standards & Certification

- Certified to AS/NZS 1270:2002



BSI Certified Product  
AS/NZS 1270:2002  
Lic. BMP 747636

## Packaging

### HLU630

Pack: 1 Pair  
Box Qty: 200 Uncorded Pairs  
Carton Qty: 10 Boxes

### HLC631

Pack: 1 Pair  
Box Qty: 100 Pairs  
Carton Qty: 10 Boxes

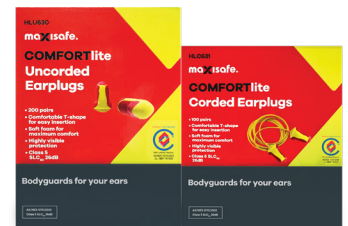

## Applications

- Agriculture & Forestry • Chemical • Construction
- Manufacturing • Metal Processing • Mining • Military
- Municipal Services • Transportation • Welding
- Woodworking

## Ordering Information

Product Code	Description
HLU630	Comfortlite T-Shaped Uncorded Earplugs
HLC631	Comfortlite T-Shaped Corded Earplugs

# Maxisafe Ergo Push & Twist Earplugs

## Sound Attenuation Values

Hearing protector Class 4 tested to AS/NZS 1270. When selected, used and maintained as specified in AS/NZS 1269, this protector may be used in noise up to 110dB, assuming an 85dB criterion. A lower criterion may require a higher protector class.

Frequency (HZ)	125	250	500	1000	2000	4000	8000	Clamping Force	SLC <sub>80</sub>	Class
Mean (dB)	26.9	28.8	29.3	29.9	32.8	40.4	44.3	N/A	26	5
SD (dB)	6.2	7	8	6.4	6.2	4.7	7.6			
Mean-SD (dB)	20.7	21.8	21.3	23.5	26.6	35.7	36.7			

**Important Note:** SLC<sub>80</sub> rating could be different in your ears as each canal is different so it is hard to get accurate readings.

Noise	Class	Noise Levels
Sandblasting / Jack Hammers	<b>5</b>	105 to less than 110
Chainsaws / Fire Pumps	<b>4</b>	100 to less than 105
Lawnmowers/Grinders	<b>3</b>	95 to less than 100
Inside Truck	<b>2</b>	90 to less than 95
Engine Room	<b>1</b>	less than 90

Determination of Class:					
Class	1	2	3	4	5
SLC <sub>80</sub> dB	10-13	14-17	18-21	22-25	26 or greater

**WARNING :** The reported attenuation of the Maxisafe ear plugs will only be obtained if it is in good condition and is fitted as directed. Reference should be made to AS/NZS: 1270:2002 to ensure the correct selection and use of protector.

Common noise sources and their typical sound levels

Typical sound level in db	Sound source
140	Jet engine at 30m (pain can be felt at this threshold)
130	Rivet hammer (pain can be felt at this threshold)
120	Rock drill
110	Chain saw Angle grinding
100	Sheet-metal workshop
90	Lawn-mower
85	Front-end loader Listening to a personal music player in a quiet room
80	Kerbside heavy traffic Lathe Welding
70	Loud conversation
60	Normal conversation
40	Quiet radio music
30	Whispering
20	Quiet urban room
10	Rustling leaves
0	Hearing threshold

Taken from Compliance Code Noise - Edition 2

## Understanding Noise and Sound Levels WORK SCALE

Safe Zone:  
**0-85db**

Protection Required:  
**From 85db**

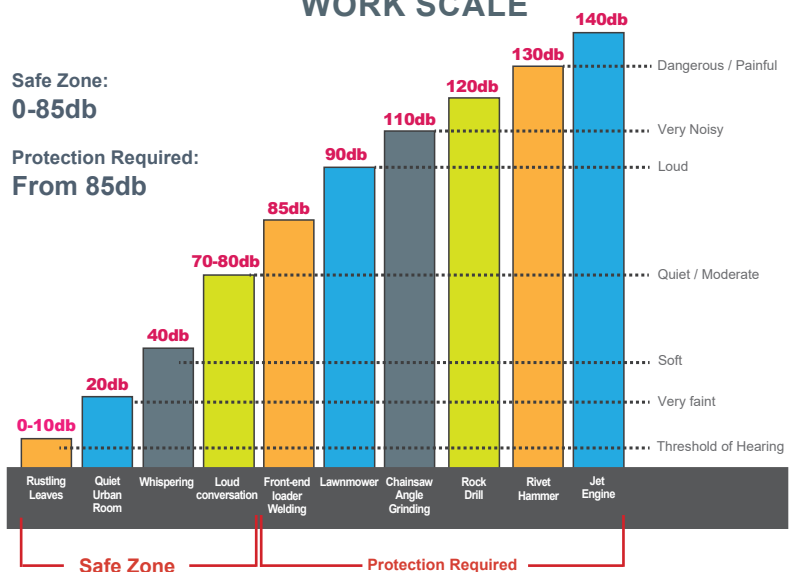

Noise is considered **Health Hazard #4** according to Worksafe Victoria  
<https://www.worksafe.vic.gov.au/noise>

For more details download a copy of Compliance Code Noise Edition 2, 2019  
 (Part 3 -Duties of Employers)  
<https://www.worksafe.vic.gov.au/resources/compliance-code-noise>